

classic plaza bench

This is a carbon neutral product.



The Classic Plaza Bench features slender battens made from eco-certified hardwood or aluminium, supported by stainless steel frames. Curved edges provide user comfort.

DIMENSIONS:

625W x 470H x various lengths (mm)
24 5/8" W x 18 1/2" H x various lengths

Select one box per category to specify your product.

LENGTH:

- 1750mm | 68 7/8"
- 2100mm | 82 11/16"
- Tailored

FRAME:

[See colour chart](#)

- Stainless 304 powder coated

MOUNTING:

- Surface fixed
- Subsurface fixed
- Core drilled (300mm below ground)

BATTEN:

- Aluminium Woodgrain [See Colour Chart](#)
- Aluminium Powder Coated [See Colour Chart](#)
- Aluminium Anodised
- Eco-certified Hardwood Oiled*

*Sourced from certified managed forests (PEFC or FSC). Hardwood needs re-oiling every 3 months. For a wood look with low maintenance, choose Aluminium Woodgrain (also known as Wood Without Worry).

BATTEN ENDCAP COLOUR:

- Match Batten
- Match Frame

Some options incur additional fees and lead time.

Need more information?

For a brochure, image gallery, CAD downloads, installation and maintenance guides, go to: streetfurniture.com/au/product/classic-plaza-bench/

Quick links:

- streetfurniture.com/au/colour-chart/
- streetfurniture.com/au/warranty/

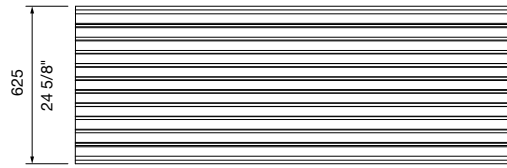

TOP VIEW

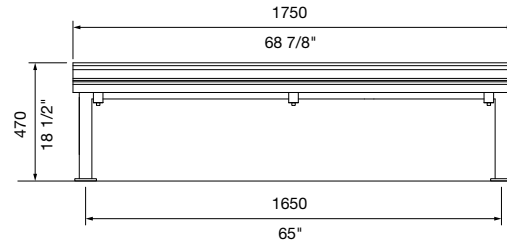

FRONT VIEW
1750mm

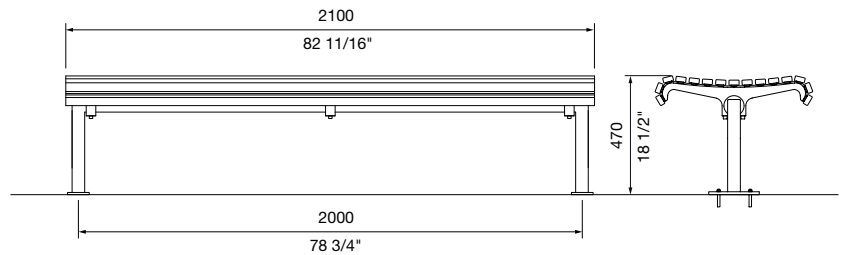

FRONT VIEW
2100mm

SIDE VIEW

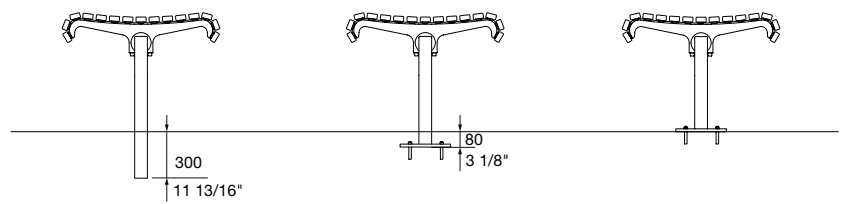

CORE DRILLED

SUBSURFACE FIXED

SUFACE FIXED

MOUNTING OPTIONS

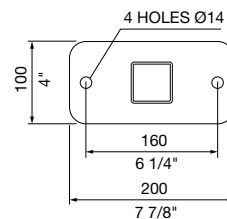

BASEPLATE DETAIL
SURFACE FIXED