

**Sun Lounges promote a relaxed vibe and attract people to parks and urban areas. Available with hardwood, anodised, powder coated and aluminium woodgrain battens.**

MCODE:  
CMM-S

DIMENSIONS:  
605L x 1645W x 905H (mm)  
23 7/8" L x 64 3/4" W x 35 5/8" H

Select one box per category to specify your product.

#### FRAME:

[See colour chart](#)

Only 316 is suitable for marine environments.

- ☐ Stainless steel 304 powder coated
- ☐ Stainless steel 316 powder coated

#### LEG AND MOUNTING:

- ☐ Bolt-on support
  - ☐ Surface fixed
  - ☐ Subsurface fixed

#### BATTEN:

[See colour chart](#)

Street Furniture Australia uses sustainable timber from certified managed forests. Timber requires oiling every three months. For a timber look with low maintenance, choose aluminium woodgrain.

- ☐ Eco-certified hardwood oiled
- ☐ Aluminium anodised
- ☐ Aluminium powder coated
- ☐ Aluminium woodgrain
- ☐ Tailored

#### BATTEN END CAP:

[See colour chart](#)

Solid powder colour applies to aluminium battens only.

- ☐ Match batten colour
- ☐ Match frame colour
- ☐ Tailored

Some options incur additional fees and lead time.

#### Need more information?

For a brochure, image gallery, CAD downloads, installation and maintenance guides, go to:  
[streetfurniture.com/au/product/mall-sun-lounge/](https://streetfurniture.com/au/product/mall-sun-lounge/)

#### Quick links:

[streetfurniture.com/au/colour-chart/](https://streetfurniture.com/au/colour-chart/)  
[streetfurniture.com/au/warranty/](https://streetfurniture.com/au/warranty/)

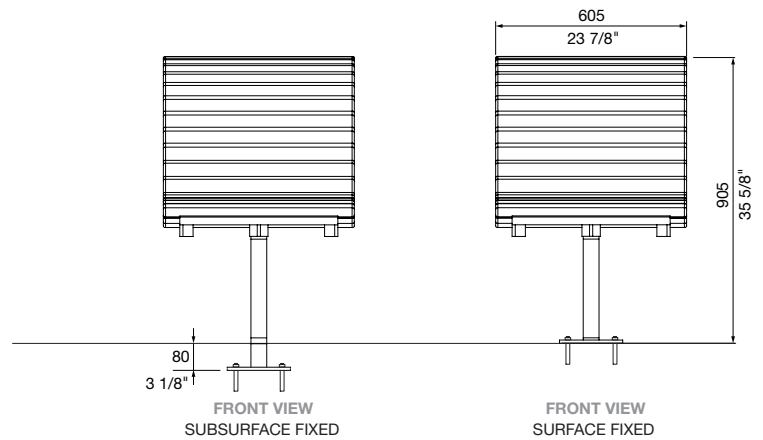

#### MOUNTING OPTIONS

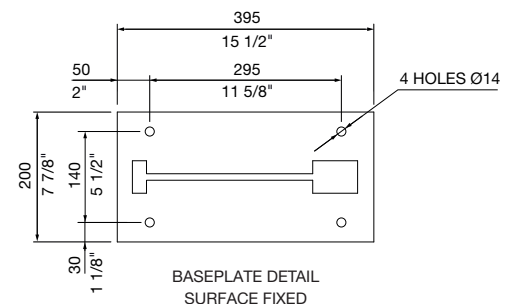
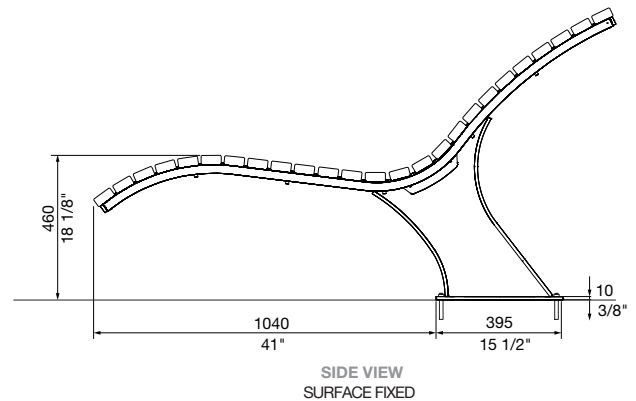
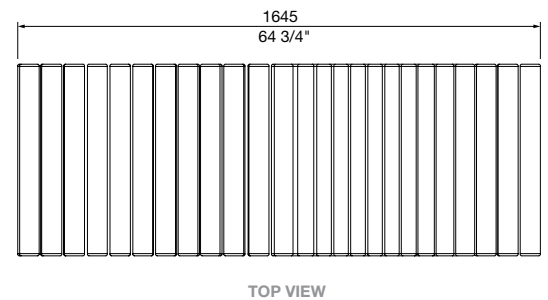

**Sun Lounges promote a relaxed vibe and attract people to parks and urban areas. Available with hardwood, anodised, powder coated and aluminium woodgrain battens.**

MCODE:  
CMM-SW

DIMENSIONS:  
1210L x 1645W x 905H (mm)  
47 5/8" L x 64 3/4" W x 35 5/8" H

Select one box per category to specify your product.

#### FRAME:

[See colour chart](#)

Only 316 is suitable for marine environments.

- ☐ Stainless steel 304 powder coated
- ☐ Stainless steel 316 powder coated

#### LEG AND MOUNTING:

- ☐ Bolt-on support
  - ☐ Surface fixed
  - ☐ Subsurface fixed

#### BATTEN:

[See colour chart](#)

Street Furniture Australia uses sustainable timber from certified managed forests. Timber requires oiling every three months. For a timber look with low maintenance, choose aluminium woodgrain.

- ☐ Eco-certified hardwood oiled
- ☐ Aluminium anodised
- ☐ Aluminium powder coated
- ☐ Aluminium woodgrain
- ☐ Tailored

#### BATTEN END CAP:

[See colour chart](#)

Solid powder colour applies to aluminium battens only.

- ☐ Match batten colour
- ☐ Match frame colour
- ☐ Tailored

Some options incur additional fees and lead time.

#### Need more information?

For a brochure, image gallery, CAD downloads, installation and maintenance guides, go to:  
[streetfurniture.com/au/product/mall-sun-lounge/](https://streetfurniture.com/au/product/mall-sun-lounge/)

#### Quick links:

[streetfurniture.com/au/colour-chart/](https://streetfurniture.com/au/colour-chart/)  
[streetfurniture.com/au/warranty/](https://streetfurniture.com/au/warranty/)

