

**A helical double-sided stand that provides whole support for the bicycle frame and wheels. Complies with AS2890.3 Class 3.**

MCODE:  
BST04

**DIMENSIONS:**  
720L x 370W x 850H (mm)  
28 3/8" L x 14 5/8" W x 33 1/2" H

Select one box per category to specify your product.

**PIPE:**

- ☐ Stainless 304 No.4 finish (brushed)
- ☐ Stainless 316 No.4 finish (brushed)
- ☐ Tailored

**MOUNTING:**

- ☐ Surface fixed
- ☐ Subsurface fixed
- ☐ Core drilled (300mm below ground)
- ☐ Tailored

*Some options incur additional fees and lead time.*

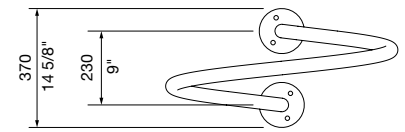

TOP VIEW

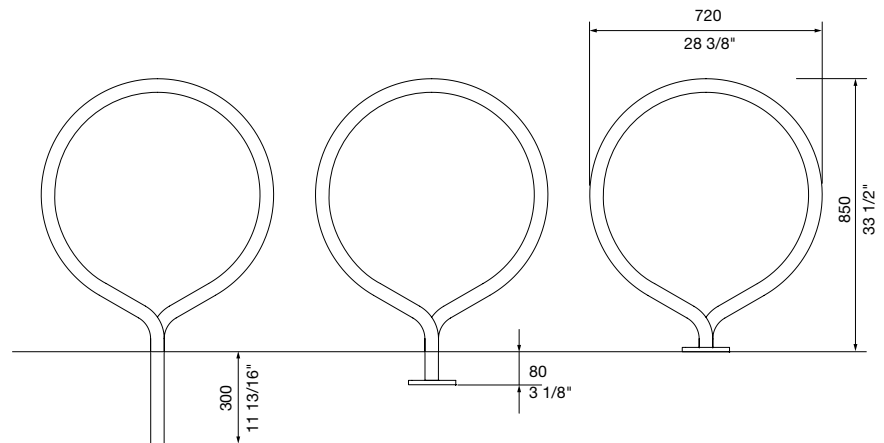

CORE DRILLED

SUBSURFACE FIXED

SURFACE FIXED

MOUNTING OPTIONS

**Need more information?**

For a brochure, image gallery, CAD downloads, installation and maintenance guides, go to:  
[streetfurniture.com/au/product/spiral-hoop/](https://streetfurniture.com/au/product/spiral-hoop/)

**Quick links:**

[streetfurniture.com/au/colour-chart/](https://streetfurniture.com/au/colour-chart/)  
[streetfurniture.com/au/warranty/](https://streetfurniture.com/au/warranty/)  
[streetfurniture.com/au/parts-promise/](https://streetfurniture.com/au/parts-promise/)

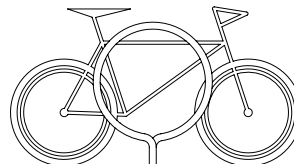

FRONT VIEW WITH BIKE

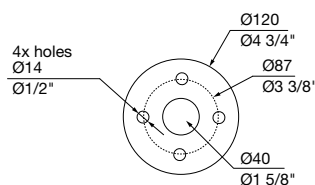

BASE PLATE DETAIL

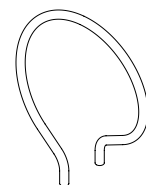

ISOMETRIC